

LEASEHOLD - SHARE OF
FREEHOLD



Flat - Purpose Built

6 STANTON COURT LONGLANDS ROAD, SIDCUP, DA15 7JZ

Asking price

£320,000

FEATURES

- TWO DOUBLE BEDROOM FIRST FLOOR APARTMENT
- CHAIN FREE SALE
- IDEALLY LOCATED FOR SIDCUP TRAIN STATION
- RARELY AVAILABLE
- ALLOCATED PARKING PLUS GARAGE
- LARGE LIVING ROOM MEASURING 16'10 X 15'6
- DOUBLE GLAZING AND GAS CENTRAL HEATING
- WESTWOODS SOLE AGENTS



Westwood
PROPERTY SERVICES

2 Bedroom Flat - Purpose Built located in Sidcup

Located on the first floor of this highly desirable and smart block of apartments Westwood's are delighted to offer this generously sized two double bedroom first floor apartment. Offered as CHAIN FREE the accommodation comprises communal entrance hall with an entry phone system, entrance hall with storage, large living room measuring 16'10 x 15'6, fitted kitchen, two good size bedrooms and a shower room. Externally there is a communal garden area as well as garage en-bloc with and allocated parking space in front. Benefitting from gas central heating, double glazing and a lease in excess of 900 years an internal viewing comes highly recommended.

Call us on

020 8301 5511

sales@westwoodpropertyservices.co.uk

Stanton Court, DA15

Approximate Gross Internal Area 66.2 sq m / 713 sq ft

Garage Area = 11.5 sq m / 124 sq ft

Total Area 77.7 sq m / 837 sq ft

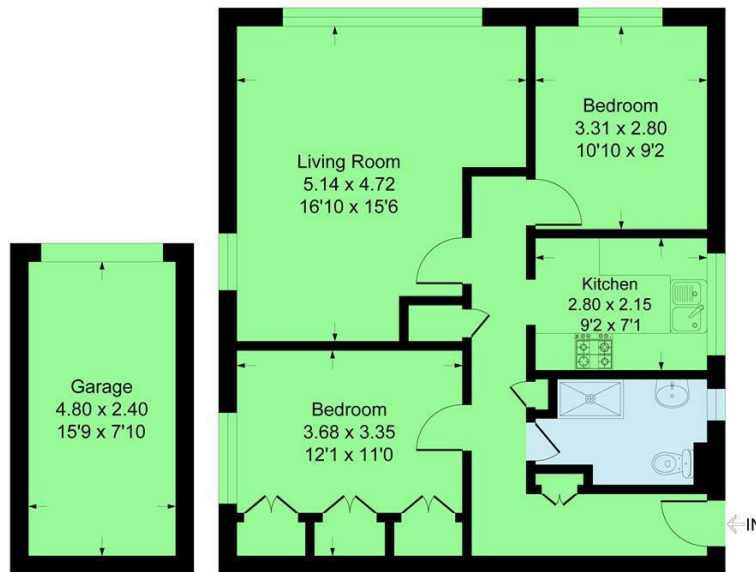

Garage

First Floor

This plan is for layout guidance only. Not drawn to scale unless stated. Windows and door openings are approximate. Whilst every care is taken in the preparation of this plan, please check all dimensions, shapes and compass bearings before making any decisions reliant upon them.

Produced By Planpix



Energy Efficiency Rating		Current	Potential
<i>Very energy efficient - lower running costs</i>			
(92 plus) A			
(81-91) B			
(69-80) C	80	80	
(55-68) D			
(39-54) E			
(21-38) F			
(1-20) G			
<i>Not energy efficient - higher running costs</i>			
England & Wales		EU Directive 2002/91/EC	

Agents Note: Whilst every care has been taken to prepare these particulars, they are for guidance purposes only. All measurements are approximate and are for general guidance purposes only and whilst every care has been taken to ensure their accuracy, they should not be relied upon and potential buyers are advised to recheck the measurements.

